

LS IA Alpax IP55 ventilated IEC motor

LSIA Ventilated Motor

Cast iron DE shield
 Cast iron NDE shield
 Stainless steel terminal box screws with plastic washer
 Stainless steel assembly rods
 Stainless steel nameplate
 IP 66 aluminium terminal box with nitrile seal
 IP 68 plastic concentric anchor gland with gasket
 NDE and DE bearings with enhanced dust and damp protection
 Plastic fan cover
 Drain holes blocked with a plug at the lowest point
 Combi seal at drive end
 Double lipseal at non drive end
 Sealing compound on the spigots

Options

IP 68 brass concentric anchor gland with gasket
 Stainless steel fan cover
 Winding with epoxy coating
 PTO/PTF/PTC thermal probes
 Stainless steel 316 shaft extension

HARSH ATMOSPHERE



ALPAX
ventilated IP55
 Var Spd: 25 to 50 Hz ...

Range: 0.18 to 9 kW

RAL 9010 epoxy finish
 System II b sheet 132

LS IA VMA VARMECA decentralised drive

LS IA VMA Ventilated Motor

Cast iron DE shield
 Cast iron NDE shield
 Stainless steel terminal box screws with plastic washer
 Stainless steel assembly rods
 Stainless steel nameplate
 IP 66 aluminium terminal box with nitrile seal
 IP 68 plastic concentric anchor gland with gasket
 NDE and DE bearings with enhanced dust and damp protection
 Plastic fan cover
 Drain holes blocked with a plug at the lowest point
 Combi seal at drive end
 Double lipseal at non drive end
 Sealing compound on the spigots

Options

IP 68 brass concentric anchor gland with gasket
 Stainless steel fan cover
 Winding with epoxy coating
 Stainless steel 316 shaft extension

HARSH ATMOSPHERE



IP55 Alpax motor
Ventilated IP65 drive
 Var Spd: range from 1 to 7

Range: 0.25 to 4 kW

RAL 9010 epoxy finish
 System II b sheet 132

FLS IAW non-ventilated IP56 KP cast iron motor

FLSIAW Non-Ventilated Motor

Cast iron DE shield
 Cast iron armoured NDE shield
 Stainless steel captive terminal box screws with plastic washer
 Stainless steel assembly rods
 Stainless steel nameplate fixed on the terminal box
 IP 66 cast iron terminal box with nitrile seal
 IP 68 plastic concentric anchor gland with gasket
 NDE and DE bearings with enhanced dust and damp protection
 Drain holes blocked with a st. steel screw at the lowest point
 Combi seal at drive end
 Sealing compound on the spigots
 B5 flange with groove for V3 or V36 mounting
 B5 or smaller B14 flange (motor output, IC410)
 Motor shaft ext. with smaller diameter (motor output, IC410)

Options

IP 68 brass concentric anchor gland with gasket
 Winding with epoxy coating
 PTO/PTF/PTC thermal probes
 Stainless steel 316 shaft extension

Range: 0.25 to 4 kW

VERY HARSH ATMOSPHERE

New



IP56 KP

CAST IRON
non-ventilated
 Var Spd: 5 to 50 Hz ...

Special surface treatment
 RAL 9010 epoxy finish
 System I b sheet 152

LS IA FCR Alpax IP55 ventilated IEC motor

LSIA FCR Ventilated Brake Motor

Cast iron DE shield
Cast iron NDE shield
Stainless steel terminal box screws with plastic washer
Stainless steel assembly rods
Stainless steel nameplate
IP 66 aluminium terminal box with nitrile seal
IP 68 plastic concentric anchor gland with gasket
NDE and DE bearings with enhanced dust and damp protection
Sheet steel fan cover with surface treatment
Drain holes blocked with a plug at the lowest point
Combi seal at drive end
Sealing compound on the spigots
FCR brake with anticorrosion protection and anti-stick treatment

Options

IP 68 brass concentric anchor gland with gasket
Winding with epoxy coating
PTO/PTF/PTC thermal probes

HARSH ATMOSPHERE



ALPAX
IP55 ventilated
Var Spd: 25 to 50 Hz ...

Range: 0.25 to 15 kW

RAL 9010 epoxy finish
System II b sheet 132

FLS IA FCR cast iron IP55 ventilated IEC motor

FLSIA FCR Ventilated Brake Motor

Cast iron DE shield
 Cast iron NDE shield
 Stainless steel terminal box screws with plastic washer
 Stainless steel assembly rods
 Stainless steel nameplate
 IP 66 cast iron terminal box with nitrile seal
 IP 68 plastic concentric anchor gland with gasket
 NDE and DE bearings with enhanced dust and damp protection
 Sheet steel fan cover with surface treatment
 Drain holes blocked with a plug at the lowest point
 Combi seal at drive end
 Sealing compound on the spigots
 FCR brake with anticorrosion protection and anti-stick treatment

Options

IP 68 brass concentric anchor gland with gasket
 Winding with epoxy coating
 PTO/PTF/PTC thermal probes

New

HARSH ATMOSPHERE

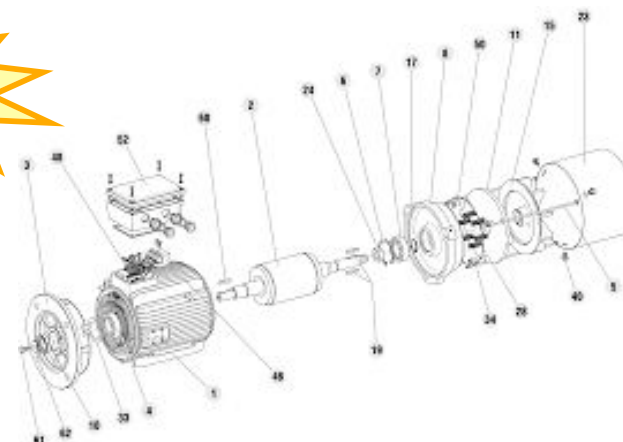

**CAST IRON
ventilated IP55**

Var Spd: 25 to 50 Hz ...

Range: 0.55 to 9 kW

RAL 9010 epoxy finish
 System II b sheet 132

LS IA Alpax IP55 ventilated IEC motor Mb IA

LSIA Ventilated Motor

Cast iron NDE and DE shields
Stainless steel terminal box screws with plastic washer
Stainless steel assembly rods
Stainless steel nameplate
IP 66 aluminium terminal box with nitrile seal
IP 68 plastic concentric anchor gland and gasket
Plastic fan cover
NDE and DE bearings with enhanced dust and damp protection
Drain holes blocked with a plug at the lowest point
Lipseal at drive end
Double lipseal at non drive end
Sealing compound on the spigots
B14 flange and IEC motor shaft extension

Options

IP 68 brass concentric anchor gland with gasket
Stainless steel fan cover
Winding with epoxy coating
PTO/PTF/PTC thermal probes

MbIA

Elimination of risks of retention
Sealing compound on the spigots
Helical fluting in the hollow shaft and lubricant reserve
Quick, simple mounting and dismounting of the client shaft
Protective cover for the lateral surface

HARSH ATMOSPHERE

Options	H1 edible oil
	Torque arm
	BS, BN, BD flanges
	Baseplate
	Slow shaft (w/o cartridge)
	Sealing cartridge



**Cast iron gearbox
Ventilated IP55 motor
Var Spd: 25 to 50 Hz ...**

**RAL 9010 epoxy finish
System II b sheet 132**

LS IA FCR Alpax IP55 ventilated IEC motor Mb IA

LSIA Ventilated Motor

Cast iron DE and NDE shields
Stainless steel terminal box screws with plastic washer
Stainless steel assembly rods
Stainless steel nameplate
IP 66 aluminium terminal box with nitrile seal
IP 68 plastic concentric anchor gland and gasket
DE and NDE bearings with enhanced dust and damp protection
Sheet steel fan cover with surface treatment
Drain holes blocked with a plug at the lowest point
Lipseal at drive end
Sealing compound on the spigots
B14 flange and IEC motor shaft extension

FCR IA Brake

FCR brake with anticorrosion protection and anti-stick treatment

Options

IP 68 brass concentric anchor gland with gasket
Winding with epoxy coating
PTO/PTF/PTC thermal probes

MbIA

Elimination of risks of retention
Sealing compound on the spigots
Helical fluting in the hollow shaft and lubricant reserve
Quick, simple mounting and dismantling of the client shaft

3992-09-2006 c Agri-foods sheets

HARSH ATMOSPHERE

Options	H1 edible oil
	Torque arm
	BS, BN, BD flanges
	Baseplate
	Slow shaft (w/o cartridge)
	Sealing cartridge



**Cast iron gearbox
Ventilated IP55 motor
Var Spd: 25 to 50 Hz ...**

**RAL 9010 epoxy finish
System II b sheet 132**

FLS IA FCR Alpax IP55 ventilated IEC motor Mb IA

FLSIA Ventilated Motor

Cast iron DE and NDE shields
Stainless steel terminal box screws with plastic washer
Stainless steel assembly rods
Stainless steel nameplate
IP 66 aluminium terminal box with nitrile seal
IP 68 plastic concentric anchor gland and gasket
DE and NDE bearings with enhanced dust and damp protection
Sheet steel fan cover with surface treatment
Drain holes blocked with a plug at the lowest point
Lipseal at drive end
Sealing compound on the spigots
B14 flange and IEC motor shaft extension

New

FCR IA Brake

FCR brake with anticorrosion protection and anti-stick treatment

Options

IP 68 brass concentric anchor gland with gasket
Winding with epoxy coating
PTO/PTF/PTC thermal probes

MbIA

Elimination of risks of retention
Sealing compound on the spigots
Helical fluting in the hollow shaft and lubricant reserve
Quick, simple mounting and dismantling of the client shaft

3992-09-2006 c Agri-foods sheets

HARSH ATMOSPHERE

Options	H1 edible oil
	Torque arm
	BS, BN, BD flanges
	Baseplate
	Slow shaft (w/o cartridge)
	Sealing cartridge



Cast iron
Ventilated IP55 motor
Var Spd: 25 to 50 Hz ...

RAL 9010 epoxy finish
System II b sheet 132

LS IA VMA decentralised drive Mb IA

LSIA VMA Ventilated Motor

Cast iron DE shield
Cast iron NDE shield
Stainless steel terminal box screws with plastic washer
Stainless steel assembly rods
Stainless steel nameplate
IP 65 aluminium terminal box with nitrile seal
IP 68 plastic concentric anchor gland with gasket
NDE and DE bearings with enhanced dust and damp protection
Plastic fan cover
Drain holes blocked with a plug at the lowest point
Lipseal at drive end
Double lipseal at non drive end
Sealing compound on the spigots
B14 flange and IEC motor shaft extension

Options

IP 68 brass concentric anchor gland with gasket
Stainless steel fan cover
Winding with epoxy coating

MbIA

Elimination of risks of retention
Sealing compound on the spigots
Helical fluting in the hollow shaft and lubricant reserve
Quick, simple mounting and dismounting of the client shaft
Protective cover for the lateral surface

HARSH ATMOSPHERE

Options	H1 edible oil
	Torque arm
	BS, BN, BD flanges
	Baseplate
	Slow shaft (w/o cartridge)
	Sealing cartridge



Cast iron gearbox
Ventilated IP65 drive
Var Spd: range from 1 to 7

RAL 9010 epoxy finish
System II b sheet 132

LS IAW cast iron IP56 KP non-ventilated motor Mb IAW IP66 K

FLSIAW Non-Ventilated Motor

Cast iron DE shield
Cast iron armoured NDE shield
Captive stainless steel terminal box screws with plastic washer
Stainless steel assembly rods
Stainless steel nameplate fixed on the terminal box
IP 66 cast iron terminal box with nitrile seal
IP 68 plastic concentric anchor gland with gasket
NDE and DE bearings with enhanced dust and damp protection
Drain holes blocked with a st. steel screw at the lowest point
Lipseal at drive end
Sealing compound on the spigots
B14 flange & motor shaft ext. with smaller diameter (motor output)

Options

IP 68 brass concentric anchor gland with gasket
Winding with epoxy coating
PTO/PTF/PTC thermal probes

MbIAW

Elimination of risks of retention
Sealing compound on the spigots
Helical fluting in the hollow shaft and lubricant reserve
Quick, simple mounting and dismantling of the client shaft
Protective cover for the lateral surface
Sealing cartridge for the hollow shaft

VERY HARSH ATMOSPHERE

Options	H1 edible oil
	Torque arm
	BS flanges
	Baseplate

IP66 KP

New



CAST IRON
IP66 KP assembly
Var Spd: 5 to 50 Hz ...

Special surface treatment
RAL 9010 epoxy finish
System I b sheet 152

LS IA Alpax IP55 ventilated motor Cb IA

LSIA Ventilated Motor

Cast iron NDE and DE shields
 Stainless steel terminal box screws with plastic washer
 Stainless steel assembly rods
 Stainless steel nameplate
 IP 66 aluminium terminal box with nitrile seal
 IP 68 plastic concentric anchor gland with gasket
 NDE and DE bearings with enhanced dust and damp protection
 Plastic fan cover
 Drain holes blocked with a plug at the lowest point
 Lipseal at drive end, double lipseal at non drive end
 Sealing compound on the spigots
 Integral mounting

Options

IP 68 brass concentric anchor gland with gasket
 Stainless steel fan cover
 PTO/PTF/PTC thermal probes
 Winding with epoxy coating

CbIA

Elimination of risks of retention
 Sealing compound on the spigots
 Hexagonal headed screws
 Breather plug with labyrinth seal

HARSH ATMOSPHERE



Options	H1 edible oil
	BS flange
	BD1, BD2, BD3 flanges
	BT flange

Cast iron gearbox
Ventilated IP55 motor
 Var Spd: 25 to 50 Hz ...

RAL 9010 epoxy finish
 System II b sheet 132

LS IA FCR Alpax IP55 ventilated motor Cb IA

LSIA Ventilated Motor

Cast iron NDE and DE shields
 Stainless steel terminal box screws with plastic washer
 Stainless steel assembly rods
 Stainless steel nameplate
 IP 66 aluminium terminal box with nitrile seal
 IP 68 plastic concentric anchor gland with gasket
 NDE and DE bearings with enhanced dust and damp protection
 Sheet steel fan cover with surface treatment
 Drain holes blocked with a plug at the lowest point
 Lipseal at drive end
 Sealing compound on the spigots
 Integral mounting

FCR IA Brake

FCR brake with anticorrosion protection and anti-stick treatment

Options

IP 68 brass concentric anchor gland with gasket
 PTO/PTF/PTC thermal probes
 Winding with epoxy coating

CbIA

Elimination of risks of retention
 Sealing compound on the spigots
 Hexagonal headed screws
 Breather plug with labyrinth seal

HARSH ATMOSPHERE



Options	H1 edible oil
	BS flange
	BD1, BD2, BD3 flanges
	BT flange

Cast iron gearbox
Ventilated IP55 motor
Var Spd: 25 to 50 Hz ...

RAL 9010 epoxy finish
 System II b sheet 132

FLS IA FCR Alpax IP55 ventilated motor Cb IA

FLSIA Ventilated Motor

Cast iron NDE and DE shields
 Stainless steel terminal box screws with plastic washer
 Stainless steel assembly rods
 Stainless steel nameplate
 IP 66 cast iron terminal box with nitrile seal
 IP 68 plastic concentric anchor gland with gasket
 NDE and DE bearings with enhanced dust and damp protection
 Sheet steel fan cover with surface treatment
 Drain holes blocked with a plug at the lowest point
 Lipseal at drive end
 Sealing compound on the spigots
 Integral mounting

New

FCR IA Brake

FCR brake with anticorrosion protection and anti-stick treatment

Options

IP 68 brass concentric anchor gland with gasket
 PTO/PTF/PTC thermal probes
 Winding with epoxy coating

CbIA

Elimination of risks of retention
 Sealing compound on the spigots
 Hexagonal headed screws
 Breather plug with labyrinth seal

HARSH ATMOSPHERE

Options	H1 edible oil
	BS flange
	BD1, BD2, BD3 flanges
	BT flange

Cast iron
Ventilated IP55 motor
Var Spd: 25 to 50 Hz ...

RAL 9010 epoxy finish
 System II b sheet 132

LS IA VMA decentralised drive Cb IA

LSIA VMA Ventilated Motor

Cast iron DE shield
 Cast iron NDE shield
 Stainless steel terminal box screws with plastic washer
 Stainless steel assembly rods
 Stainless steel nameplate
 IP 66 aluminium terminal box with nitrile seal
 IP 68 plastic concentric anchor gland with gasket
 NDE and DE bearings with enhanced dust and damp protection
 Plastic fan cover
 Drain holes blocked with a plug at the lowest point
 Lipseal at drive end, double lipseal at non drive end
 Sealing compound on the spigots
 Integral mounting

Options

IP 68 brass concentric anchor gland with gasket
 Stainless steel fan cover
 Winding with epoxy coating

CbIA

Elimination of risks of retention
 Sealing compound on the spigots
 Hexagonal headed screws
 Breather plug with labyrinth seal

HARSH ATMOSPHERE



Options	H1 edible oil
	BS flange
	BD1, BD2, BD3 flanges
	BT flange

Cast iron gearbox
Ventilated IP65 drive
 Var Sp: range from 1 to 7

RAL 9010 epoxy finish
 System II b sheet 132

FLS IAW cast iron IP56 KP non-ventilated motor CbIAW IP66 KP

FLSIAW Non-Ventilated Motor

Cast iron DE shield
Cast iron armoured NDE shield
Stainless steel captive terminal box screws with plastic washer
Stainless steel assembly rods
Stainless steel nameplate fixed on the terminal box
IP 66 cast iron terminal box with nitrile seal
IP 68 plastic concentric anchor gland with gasket
NDE and DE bearings with enhanced dust and damp protection
Drain holes blocked with a plug at the lowest point
Lipseal at drive end, double lipseal at non drive end
Sealing compound on the spigots
Integral mounting

Options

IP 68 brass concentric anchor gland with gasket
Winding with epoxy coating
PTO/PTF/PTC thermal probes

CbIAW

Elimination of risks of retention
Sealing compound on the spigots
Hexagonal headed screws
Breather plug with labyrinth seal

VERY HARSH ATMOSPHERE

New



IP66 KP

Options	H1 edible oil
	St. steel gearbx shaft ext

CAST IRON
IP66 KP assembly
Var Spd: 5 to 50 Hz ...

Special surface treatment
RAL 9010 epoxy finish
System I b sheet 152